



SPC Trading Company
www.spc-trading.com

旋涡气泵

VORTEX GAS PUMP



HG-90B

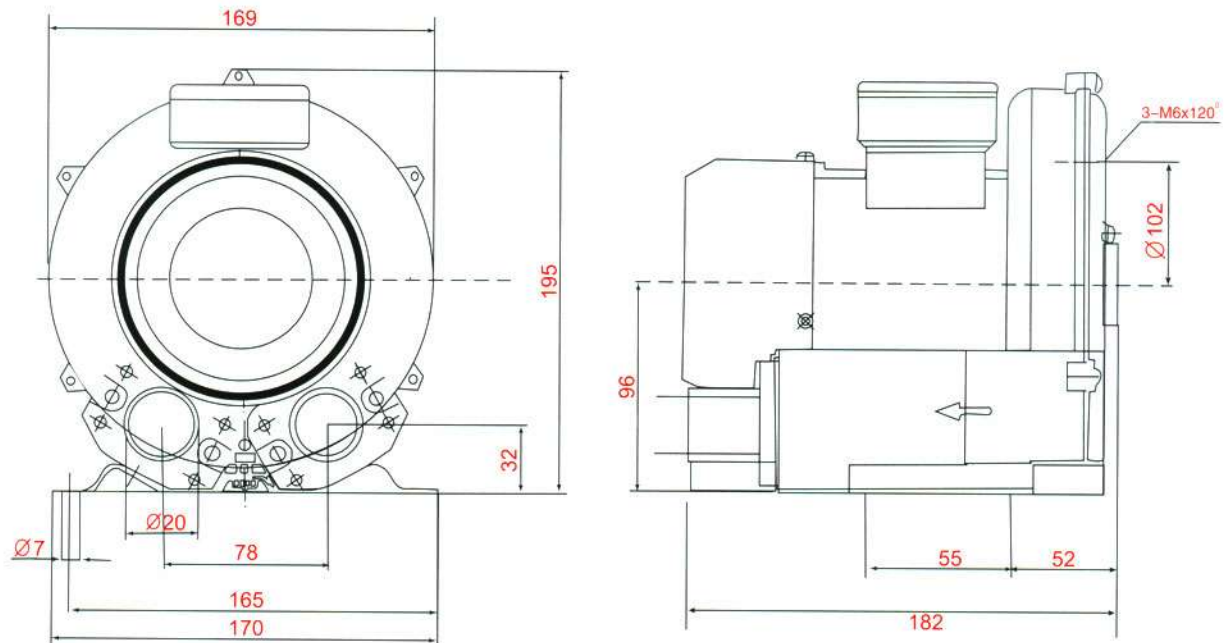

HG系列旋涡气泵性能曲线
(仅供参考不作检测依据)

吸入(indraft)

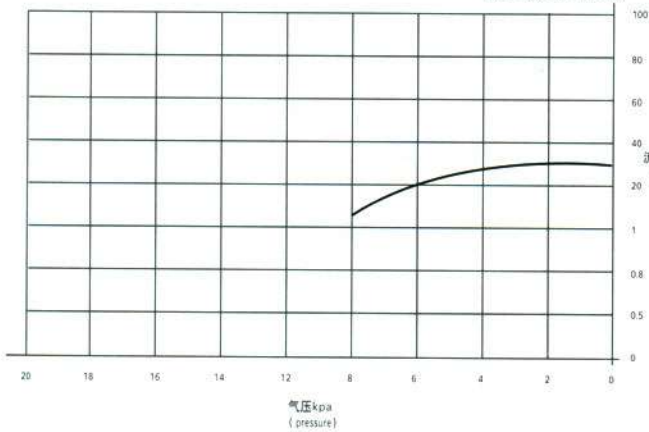

the technology parameter of the HG series vortex gas pump
(only for reference,not for test gist)

吐出(disgorge)

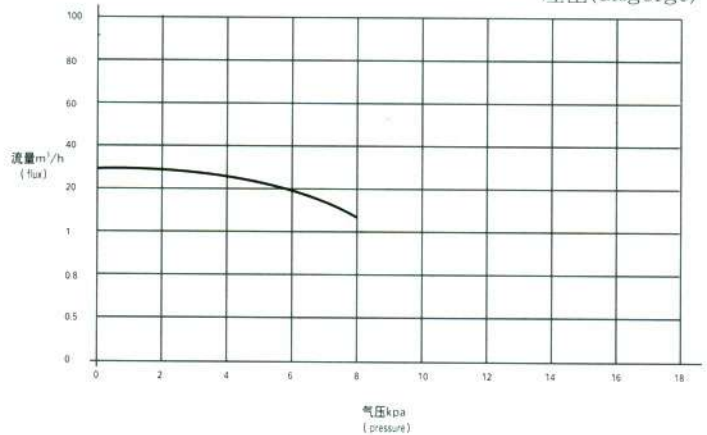

When ordering, please indicate voltage and periodicity (any voltage are also ok)
订货时, 请注明电压及周波数 (任何电压均可)

型号 Type	额定电压 Voltage V	额定电流 Current A	频率 Frequency Hz	最大气压 Max. air pressure KPa	最大流量 Max. flux M³/h	最大真空度 Max. vacu- um degree -KPa	电机功率 Power KW	转速 Rotate speed r/min	噪音 Noise LwadB	重量 Suttle Kg	装箱体积 box up volumn (cm³)
HG-90B	220-240	0.51 (0.62)	50 (60)	8	30	4	0.09 (0.18)	2800 (3400)	≤60	5.2	22.6 × 20 × 21.8

The data are only for reference in the form the factory does not issue a separate notice to data modification
表中数据仅供用户选型时参考, 工厂对数据修改不另行通知

旋涡气泵 VORTEX GAS PUMP



CCC
CE **HG-180B**

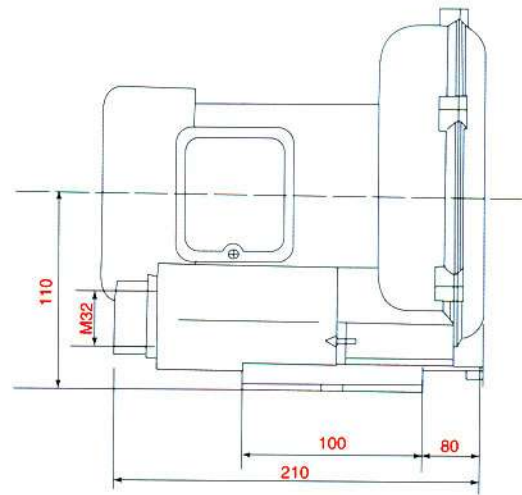
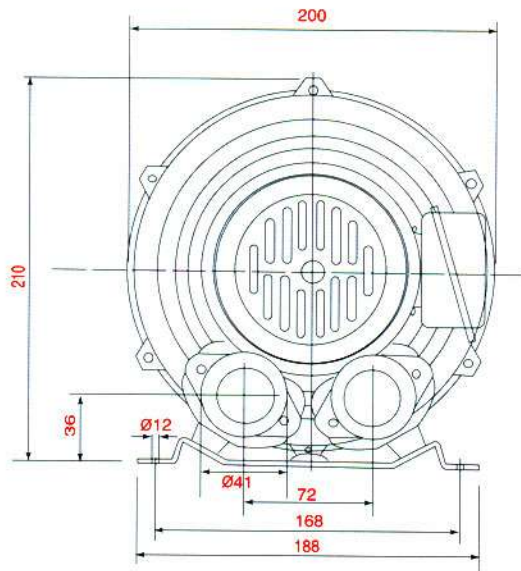

HG系列旋涡气泵性能曲线
(仅供参考不作检测依据)

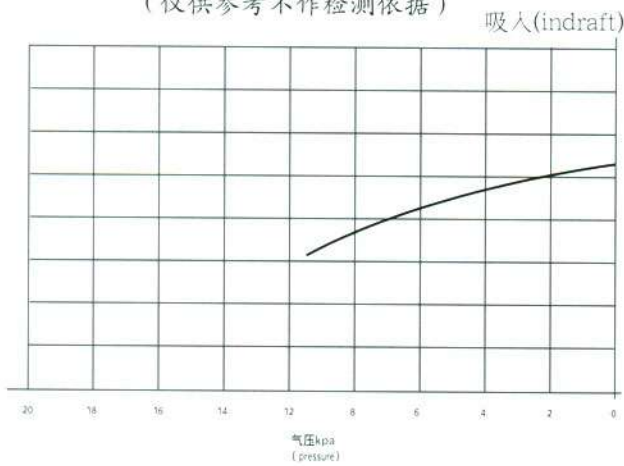

the technology parameter of the HG series vortex gas pump
(only for reference,not for test gist)

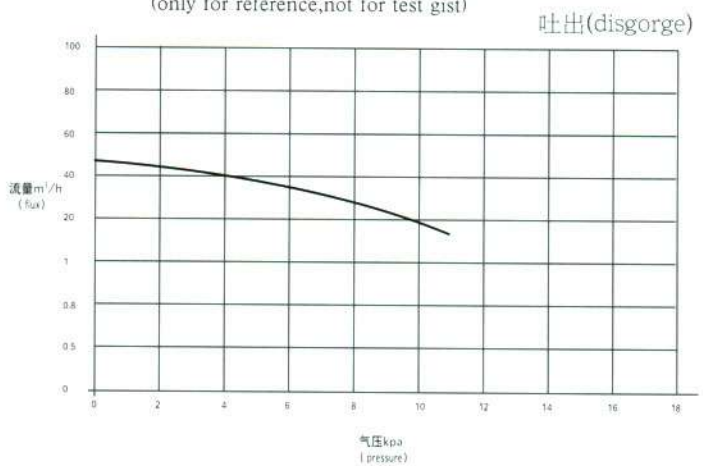

When ordering, please indicate voltage and periodicity (any voltage are also ok)
订货时, 请注明电压及周波数 (任何电压均可)

型号 Type	额定电压 Voltage V	额定电流 Curmet A	频率 Frequency Hz	最大气压 Max. air pressure KPa	最大流量 Max. flux M³/h	最大真空度 Max. vacu- um degree -KPa	电机功率 Power KW	转速 Rotate speed r/min	噪音 Noise LwadB	重量 Suttle Kg	装箱体积 box up volumn (cm³)
HG-180B	220-240	0.82 (0.98)	50 (60)	11	45	7	0.18 (0.25)	2800 (3400)	≤60	7	25 × 23 × 25

The data are only for reference in the form the factory does not issue a separate notice to data modification
表中数据仅供用户选型时参考, 工厂对数据修改不另行通知

旋涡气泵 VORTEX GAS PUMP



CCC
CE **HG-250B**

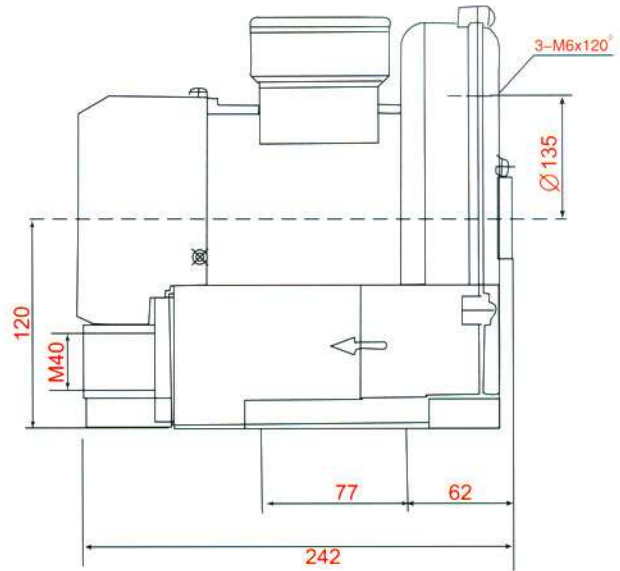
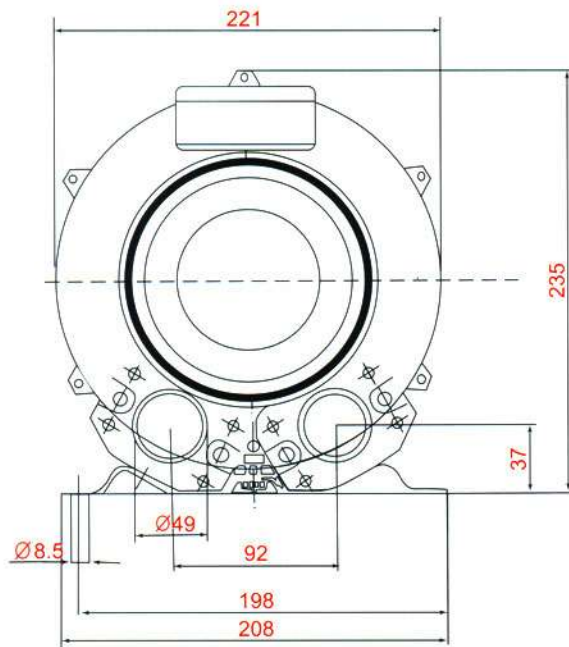

HG系列旋涡气泵性能曲线
(仅供参考不作检测依据)

吸入(indraft)

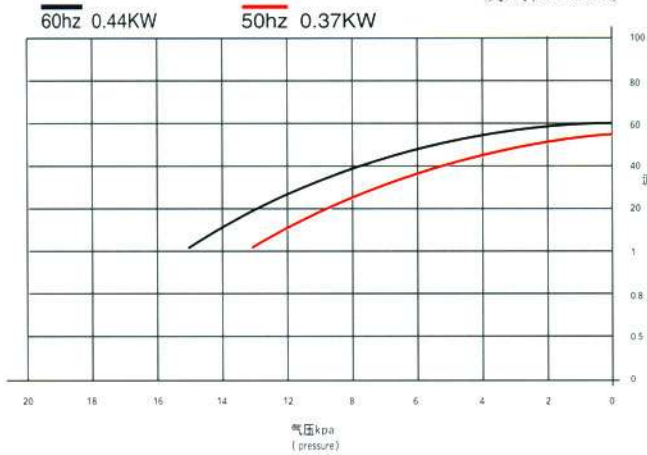

the technology parameter of the HG series vortex gas pump
(only for reference,not for test gist)

吐出(disgorge)

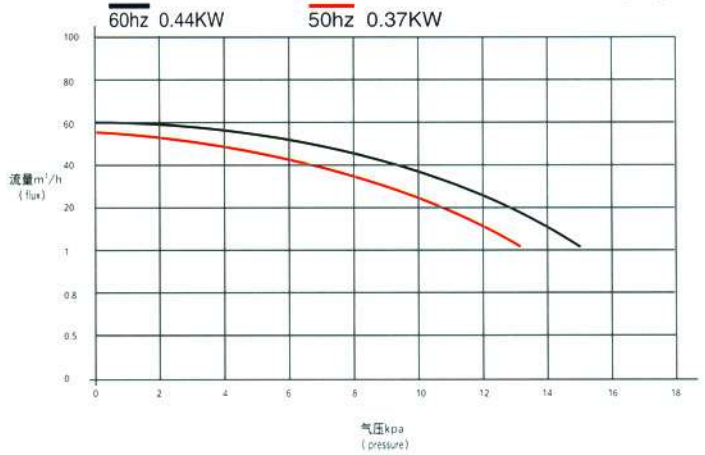

When ordering, please indicate voltage and periodicity (any voltage are also ok)
订货时, 请注明电压及周波数 (任何电压均可)

型 号 Type	额定电压 Voltage V	额定电流 Currnet A	频率 Fre- quency Hz	最大气压 Max. air pressure KPa	最大流量 Max. flux M³/h	最大真空度 Max. vacu- um degree -KPa	电机功率 Power KW	转速 Rotate speed r/min	噪音 Noise LwadB	重量 Suttle Kg	装箱体积 box up volumn (cm³)
HG-250B	220-240	1.08 (1.27)	50 (60)	13	55	9	0.25 (0.28)	2800 (3400)	≤60	8	28 × 26.5 × 28.5
HG-250SB	△ 220-240 Y 380-415	1.24 (1.68) 0.72 (0.97)	50(60)	13(15)	55(60)	9(11)	0.25(0.28)	2800 (3400)	≤60	8	28 × 26.5 × 28.5

The data are only for reference in the form the factory does not issue a separate notice to data modification
表中数据仅供用户选型时参考, 工厂对数据修改不另行通知

旋涡气泵 VORTEX GAS PUMP

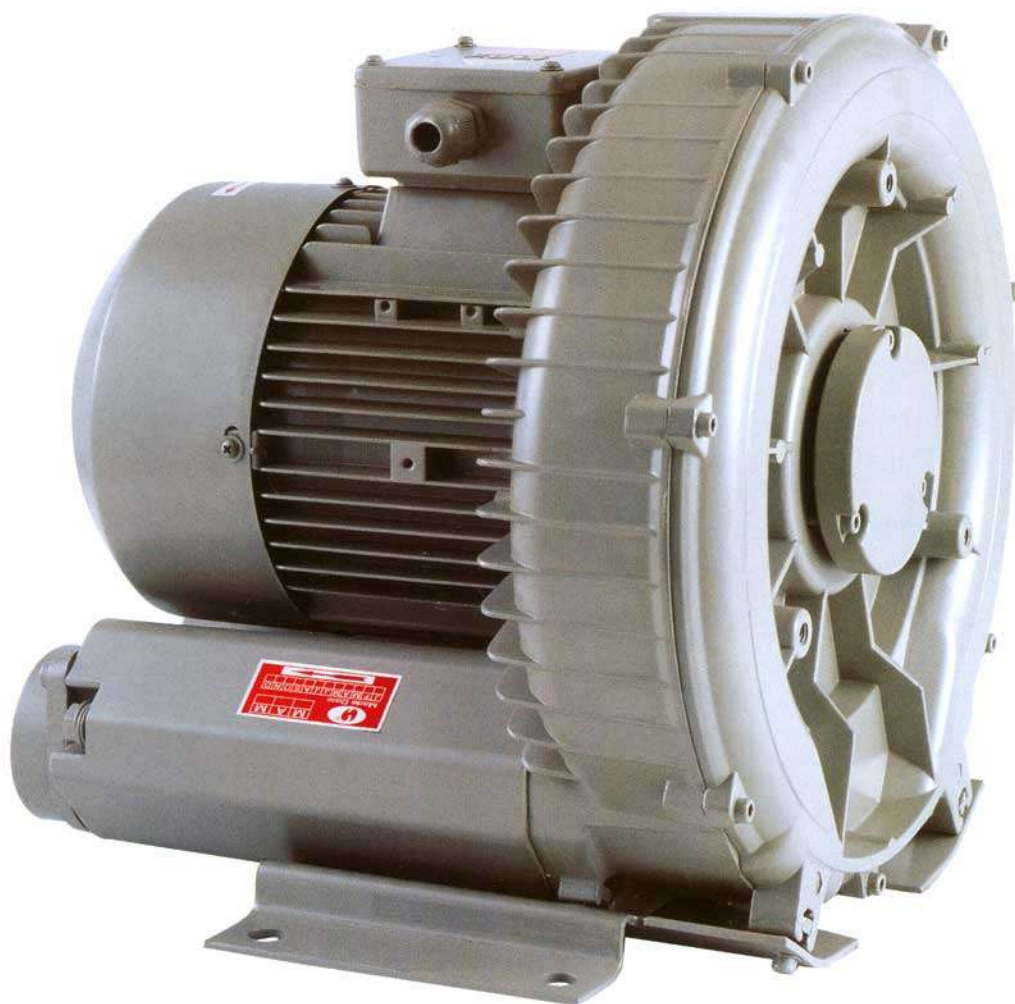

HG-1100SB

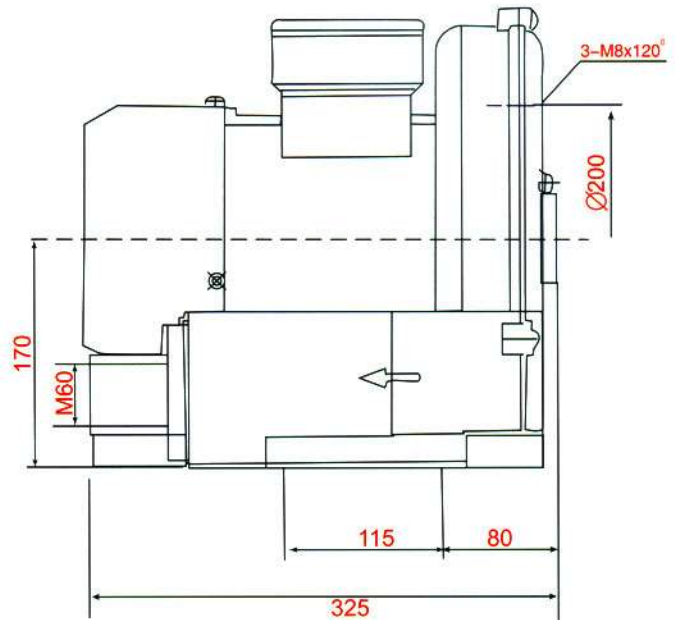
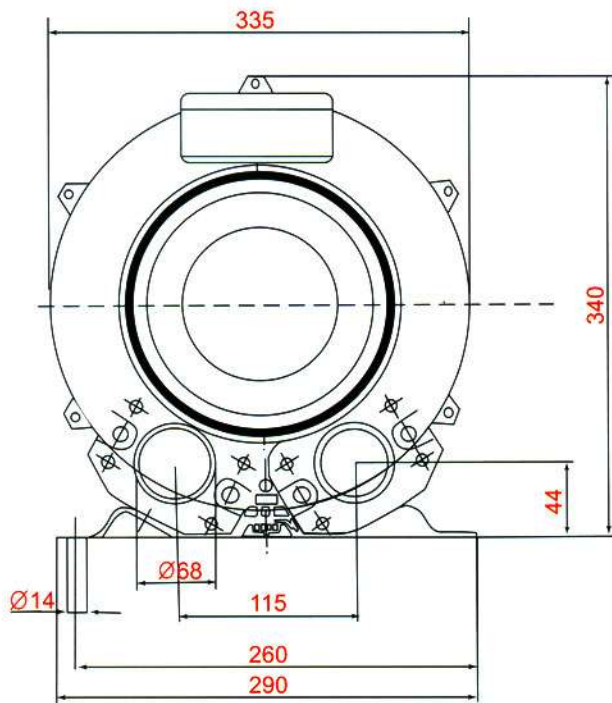

HG系列旋涡气泵性能曲线
(仅供参考不作检测依据)

the technology parameter of the HG series vortex gas pump
(only for reference, not for test gist)

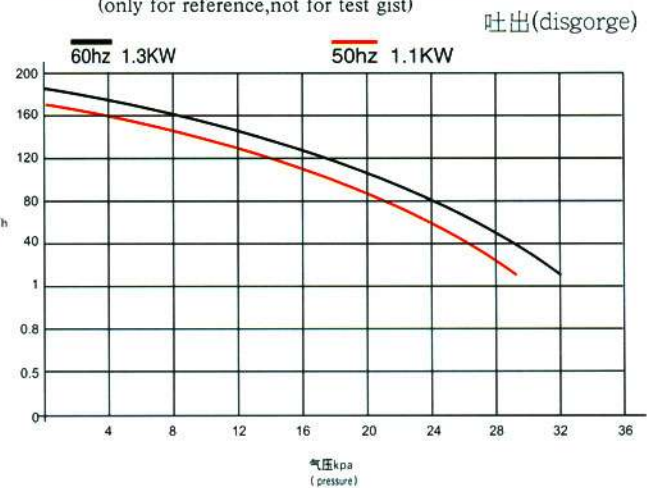
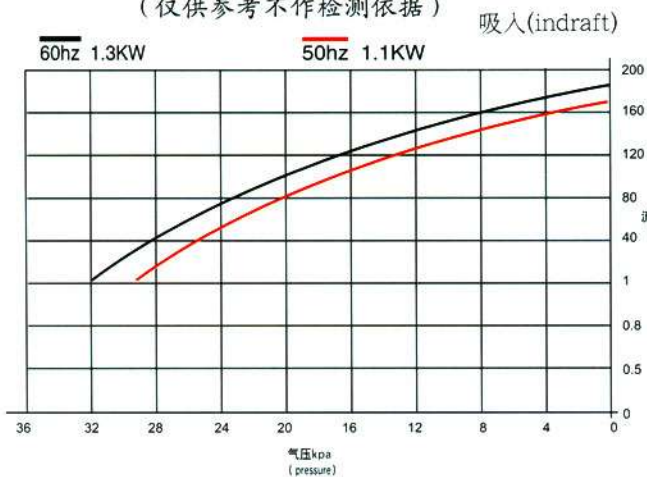

When ordering, please indicate voltage and periodicity (any voltage are also ok)
订货时, 请注明电压及周波数 (任何电压均可)

型 号 Type	额定电压 Voltage V	额定电流 Curmet A	频率 Fre- quency Hz	最大气压 Max. air pressure KPa	最大流量 Max. flux M³/h	最大真空度 Max. vacu- um degree -KPa	电机功率 Power KW	转速 Rotate speed r/min	噪音 Noise LwadB	重量 Suttle Kg	装箱体积 box up volumn (cm³)
HG-1100B	220-240	5.00 (5.89)	50 (60)	30	170	22	1.1 (1.3)	2800 (3400)	≤60	22.5	40.5 × 38 × 42
HG-1100SB	△ 220-240 Y 380-415	4.99(5.88) 2.89(3.42)	50(60)	30(32)	178(189)	22(24)	1.1(1.3)	2800 (3400)	≤60	22.5	40.5 × 38 × 42

The data are only for reference in the form the factory does not issue a separate notice to data modification
表中数据仅供用户选型时参考, 工厂对数据修改不另行通知

旋涡气泵 VORTEX GAS PUMP



HG-1500SB

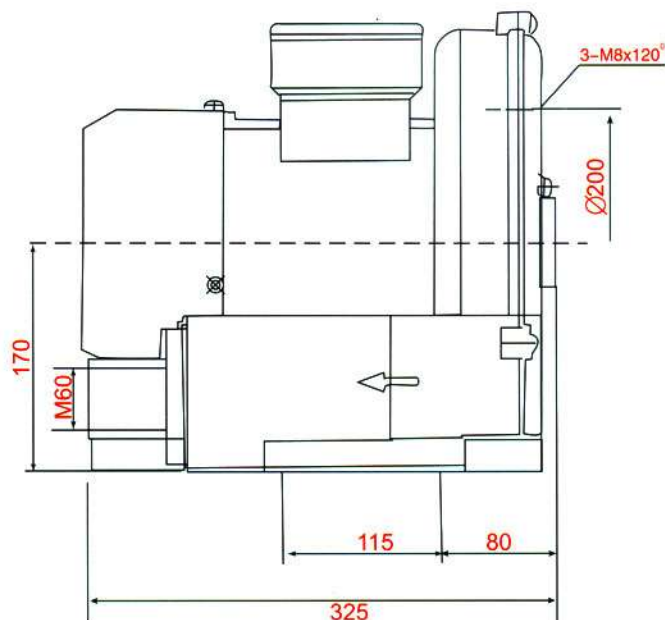
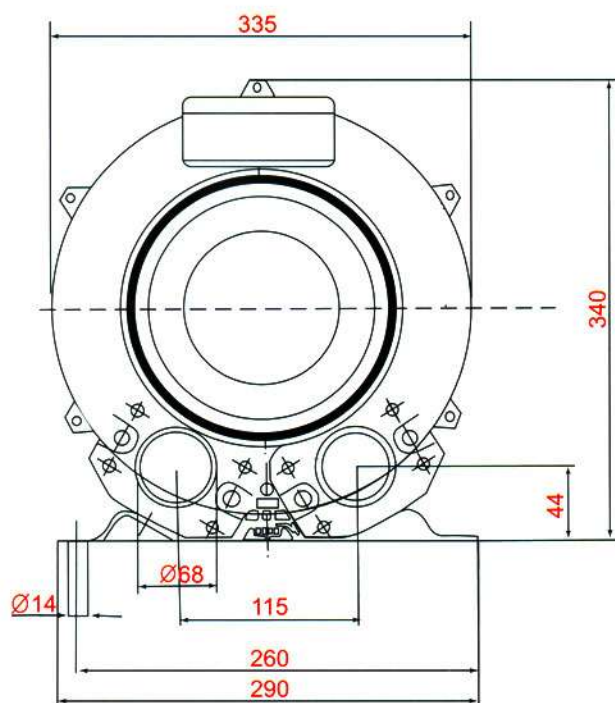

HG系列旋涡气泵性能曲线
(仅供参考不作检测依据)

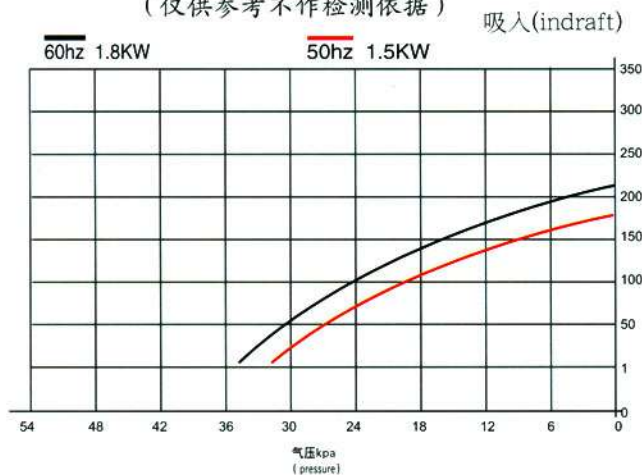

the technology parameter of the HG series vortex gas pump
(only for reference,not for test gist)

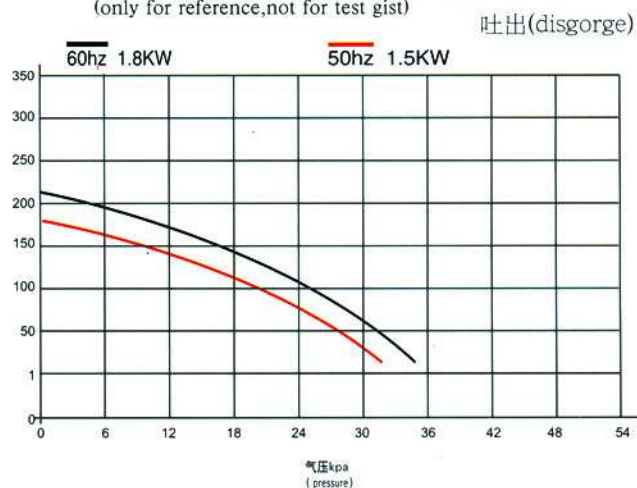

When ordering, please indicate voltage and periodicity (any voltage are also ok)
订货时, 请注明电压及周波数 (任何电压均可)

型 号 Type	额定电压 Voltage V	额定电流 Currnet A	频率 Frequency Hz	最大气压 Max. air pressure KPa	最大流量 Max. flux M³/h	最大真空度 Max. vacu- um degree -KPa	电机功率 Power KW	转速 Rotate speed r/min	噪音 Noise LwadB	重量 Suttle Kg	装箱体积 box up vol- umn (cm³)
HG-1500B	220-240	7.20 (9.10)	50 (60)	32	190	23	1.5 (1.8)	2800 (3400)	≤60	23	40.5 × 38 × 42
HG-1500SB	△ 220-240 Y 380-415	6.86(8.20) 3.94(4.74)	50(60)	32(35)	195(210)	23(25)	1.5(1.8)	2800 (3400)	≤60	23	40.5 × 38 × 42

The data are only for reference in the form the factory does not issue a separate notice to data modification
表中数据仅供用户选型时参考, 工厂对数据修改不另行通知

旋涡气泵 VORTEX GAS PUMP



HG-2200SB

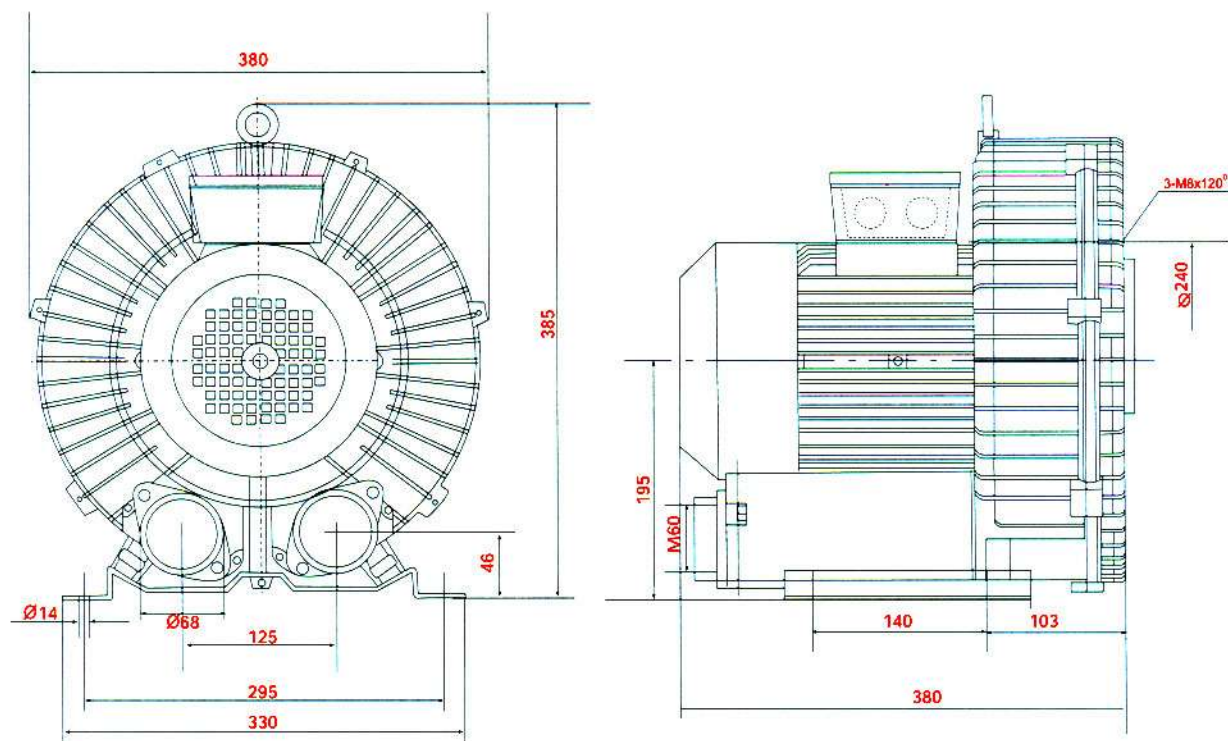

HG系列旋涡气泵性能曲线
(仅供参考不作检测依据)

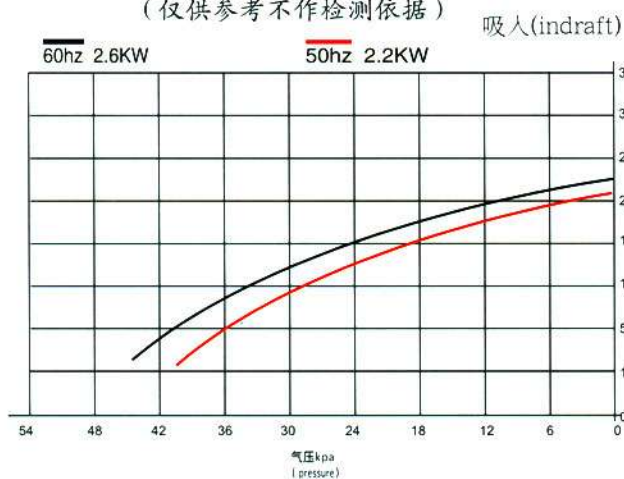

the technology parameter of the HG series vortex gas pump
(only for reference,not for test gist)

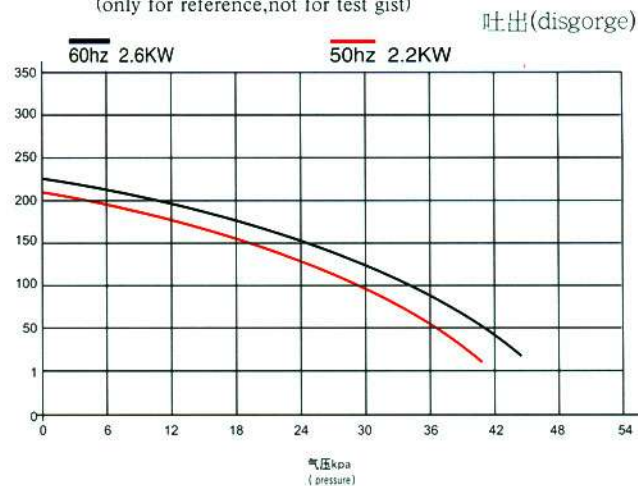

When ordering, please indicate voltage and periodicity (any voltage are also ok)
订货时, 请注明电压及周波数 (任何电压均可)

型号 Type	额定电压 Voltage V	额定电流 Current A	频率 Frequency Hz	最大气压 Max. air pressure KPa	最大流量 Max. flux M³/h	最大真空度 Max. vacu- um degree -KPa	电机功率 Power KW	转速 Rotate speed r/min	噪音 Noise LwadB	重量 Suttle Kg	装箱体积 box up vol- umn (cm³)
HG-2200SB	△ 220-240 Y 380-415	10.01(11.83) 5.79(6.84)	50(60)	40(44)	222(237)	28(32)	2.2(2.6)	2800 (3400)	≤70	35.5	47×41.5×48

The data are only for reference in the form the factory does not issue a separate notice to data modification
表中数据仅供用户选型时参考, 工厂对数据修改不另行通知

旋涡气泵 VORTEX GAS PUMP



CCC
CE **HG-3000SB**

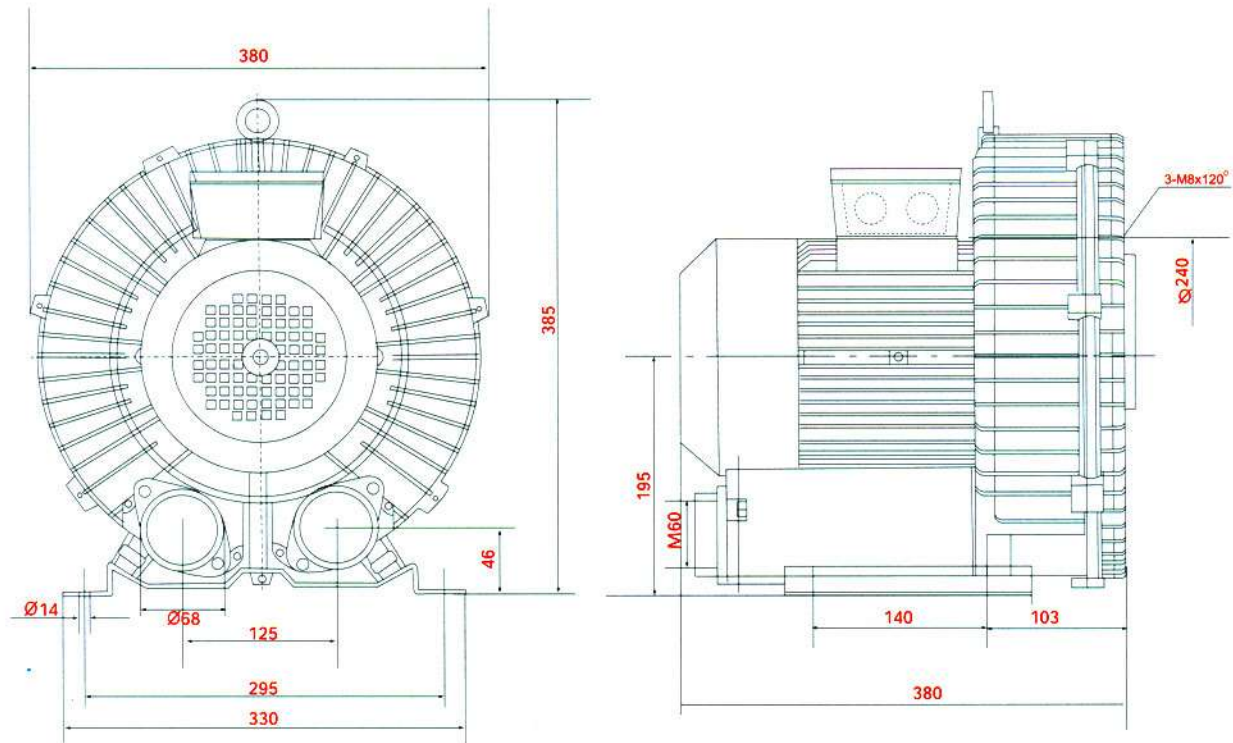

HG系列旋涡气泵性能曲线
(仅供参考不作检测依据)

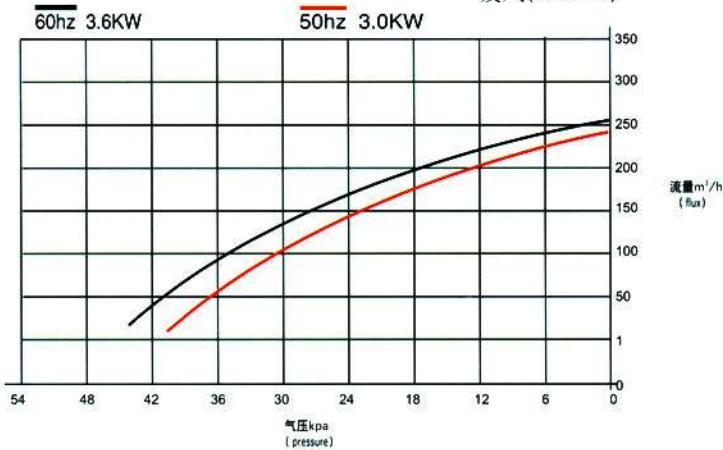

the technology parameter of the HG series vortex gas pump
(only for reference,not for test gist)

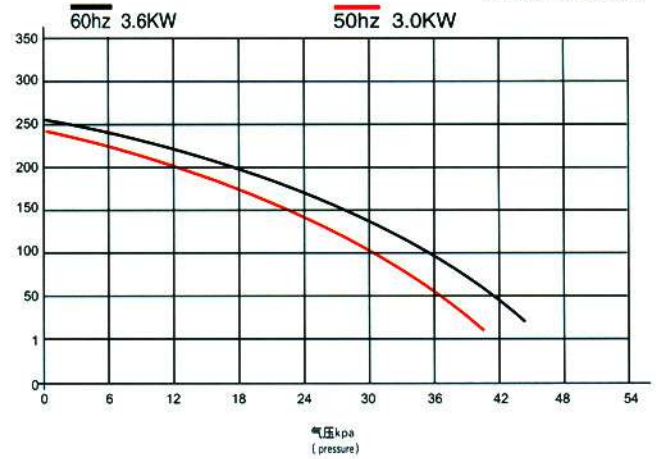

When ordering, please indicate voltage and periodicity (any voltage are also ok)
订货时, 请注明电压及周波数 (任何电压均可)

型 号 Type	额定电压 Voltage V	额定电流 Current A	频率 Fre- quency Hz	最大气压 Max. air pressure KPa	最大流量 Max. flux M³/h	最大真空度 Max. vacu- um degree -KPa	电机功率 Power KW	转速 Rotate speed r/min	噪音 Noise LwadB	重量 Suttle Kg	装箱体积 box up vol- umn (cm³)
HG-3000SB	△ 220-240 Y 380-415	13.64(16.38) 7.89(9.47)	50(60)	40(44)	245(256)	28(32)	3.0(3.6)	2800 (3400)	≤70	36	47 × 41.5 × 48

The data are only for reference in the form the factory does not issue a separate notice to data modification
表中数据仅供用户选型时参考, 工厂对数据修改不另行通知



SPC Trading Company
www.spc-trading.com

旋涡气泵

VORTEX GAS PUMP



HG-4000SB

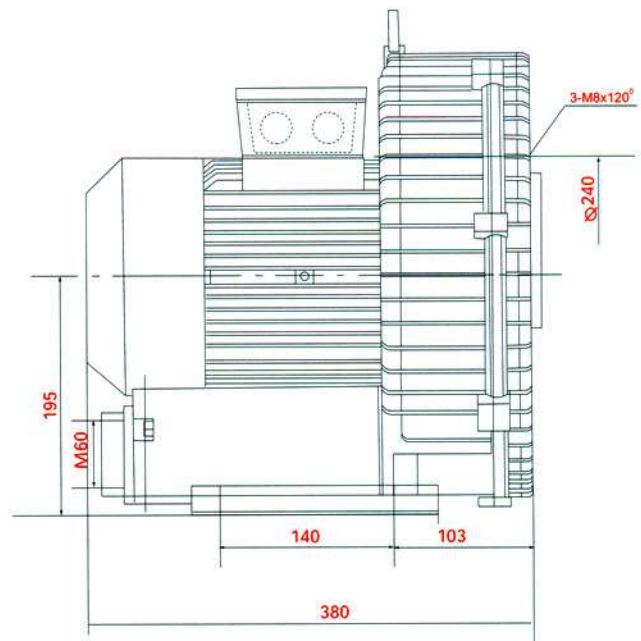
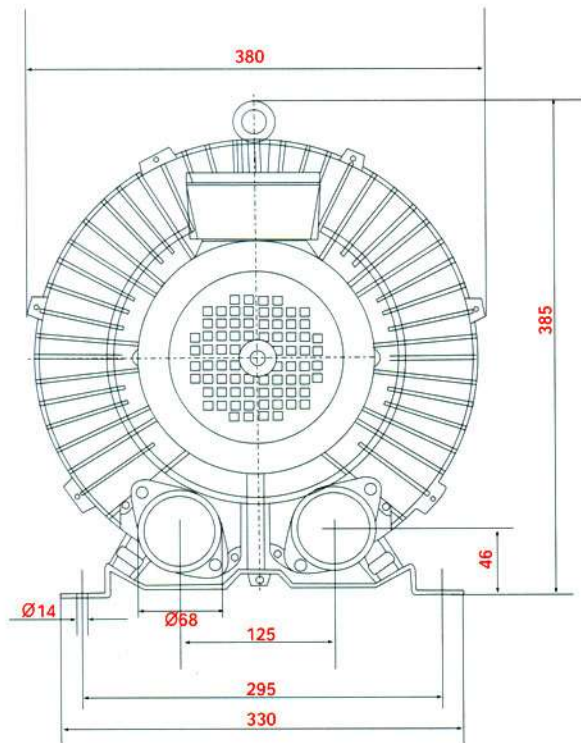

HG系列旋涡气泵性能曲线
(仅供参考不作检测依据)

吸入(indraft)

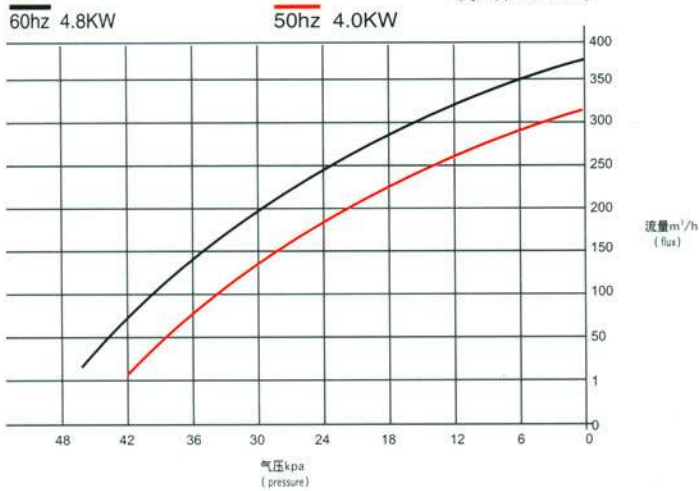

the technology parameter of the HG series vortex gas pump
(only for reference,not for test gist)

吐出(disgorge)

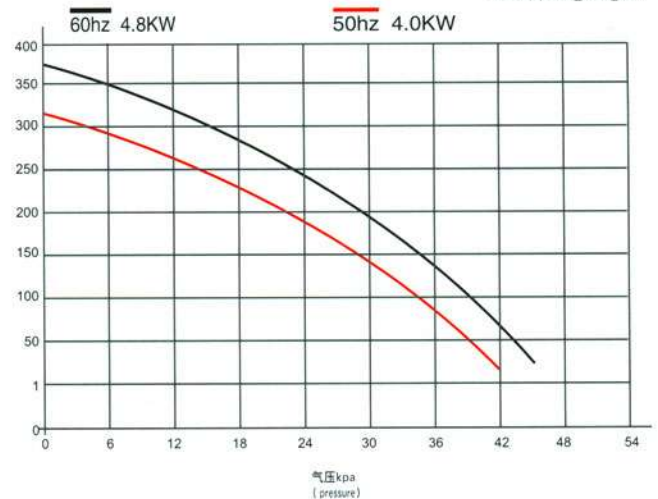

When ordering, please indicate voltage and periodicity (any voltage are also ok)
订货时, 请注明电压及周波数 (任何电压均可)

型号 Type	额定电压 Voltage V	额定电流 Current A	频率 Frequency Hz	最大气压 Max. air pressure KPa	最大流量 Max. flux M³/h	最大真空度 Max. vacuum degree -KPa	电机功率 Power KW	转速 Rotate speed r/min	噪音 Noise LwadB	重量 Suttle Kg	装箱体积 box up volumn (cm³)
HG-4000SB	△ 220-240 Y 380-415	18.22(21.85) 10.53(12.63)	50(60)	42(46)	315(370)	30(34)	4.0(4.8)	2800 (3400)	≤70	40	47 × 41.5 × 48

The data are only for reference in the form the factory does not issue a separate notice to data modification
表中数据仅供用户选型时参考, 工厂对数据修改不另行通知

旋涡气泵 VORTEX GAS PUMP

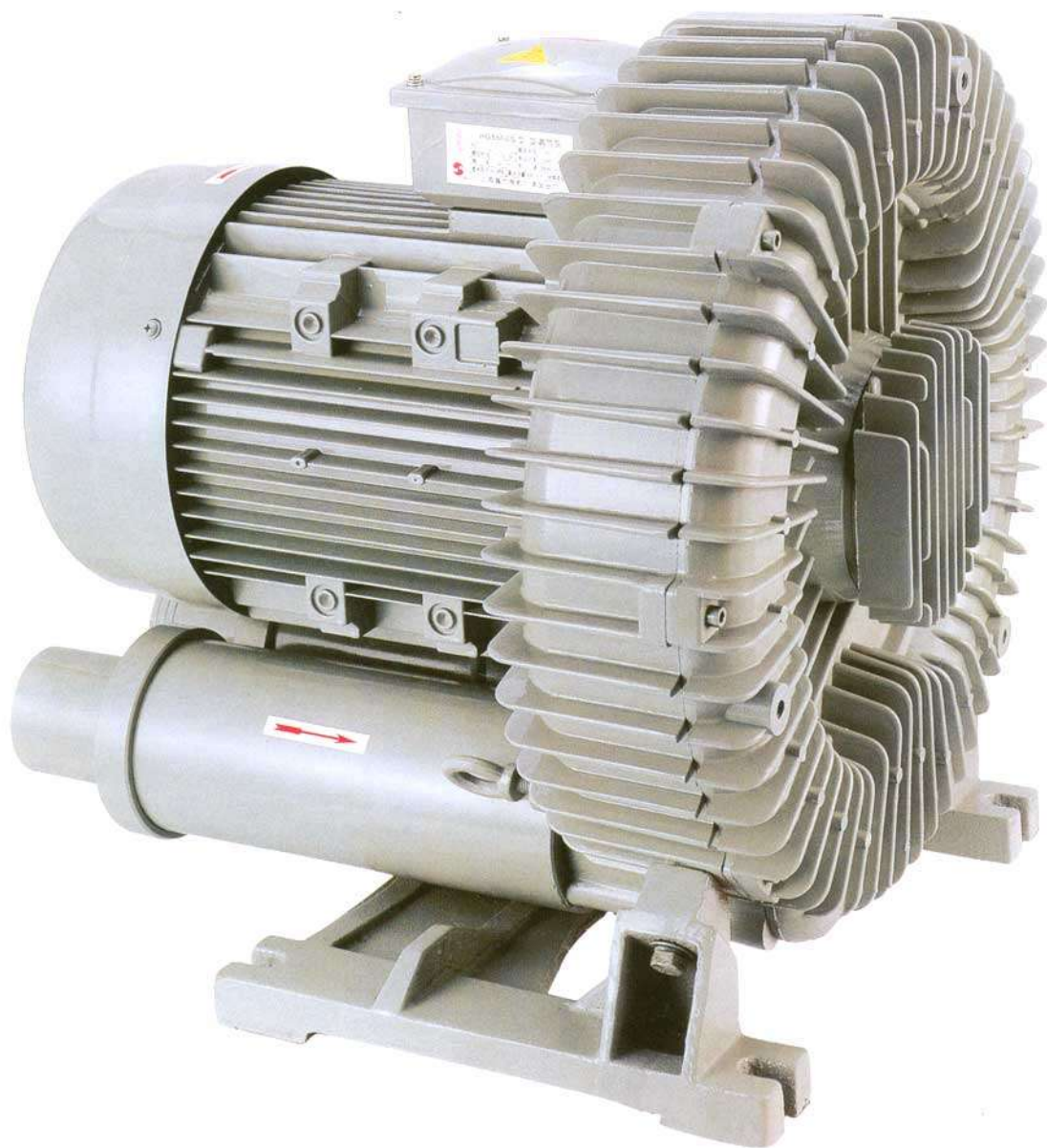

HG-5500SB

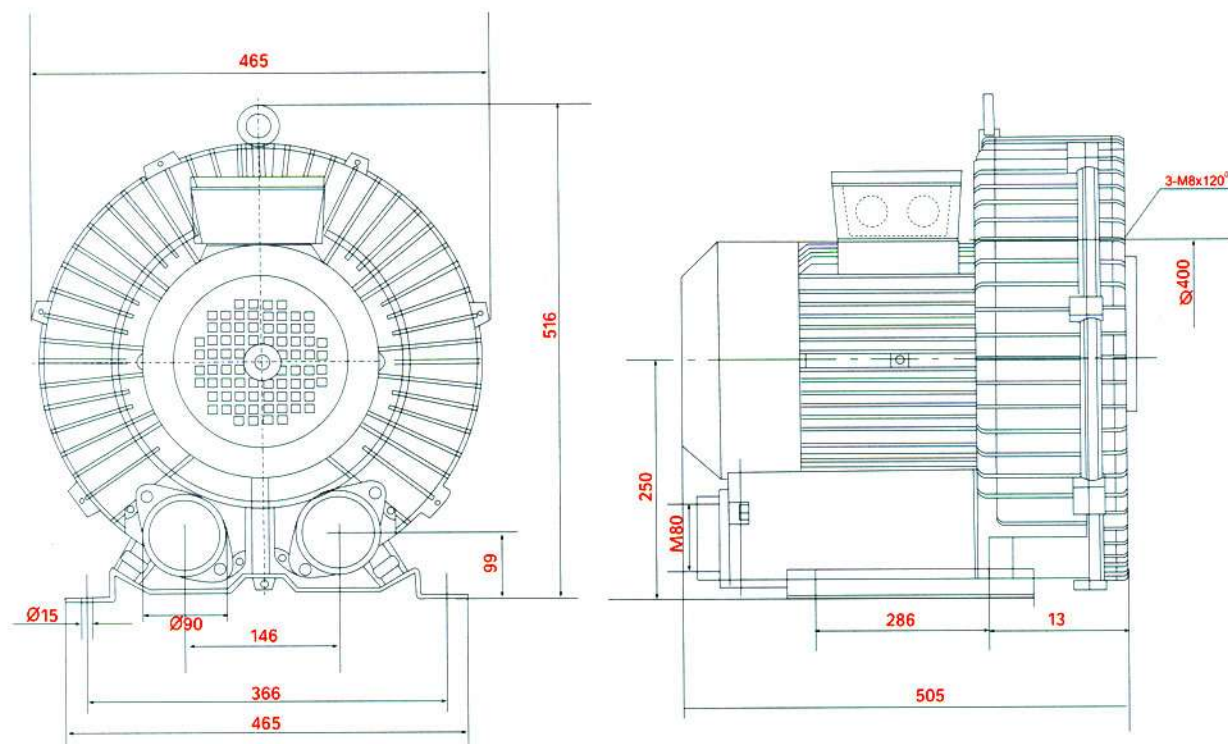

HG系列旋涡气泵性能曲线
(仅供参考不作检测依据)

the technology parameter of the HG series vortex gas pump
(only for reference,not for test gist)

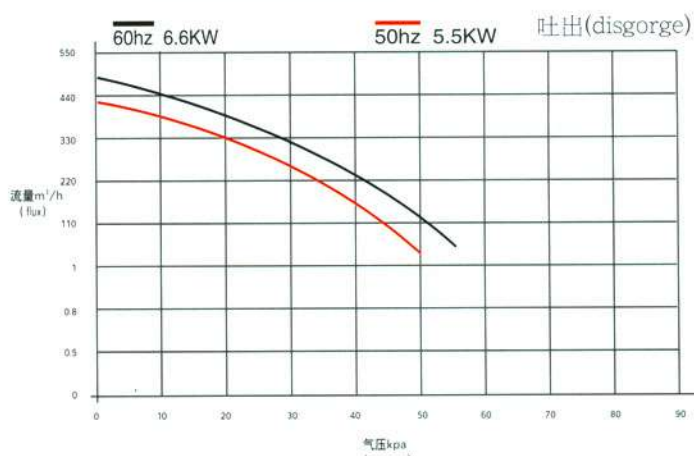
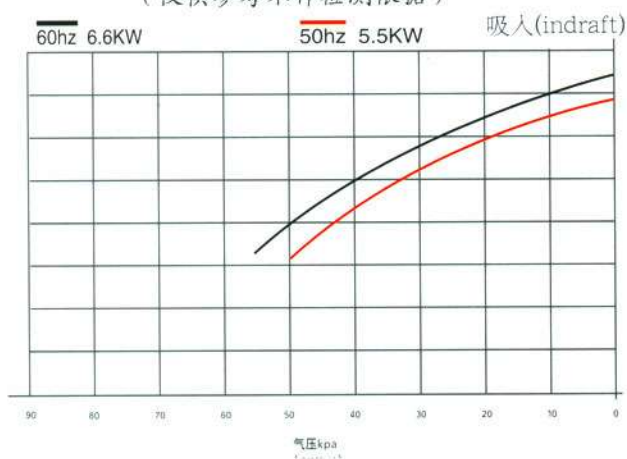

When ordering, please indicate voltage and periodicity (any voltage are also ok)
订货时, 请注明电压及周波数 (任何电压均可)

型 号 Type	额定电压 Voltage V	额定电流 Current A	频率 Fre- quency Hz	最大气压 Max. air pressure KPa	最大流量 Max. flux M³/h	最大真空度 Max. vacu- um degree -KPa	电机功率 Power KW	转速 Rotate speed r/min	噪音 Noise LwadB	重量 Suttle Kg	装箱体积 box up volumn (cm³)
HG-5500SB	△380-415	11.47 (15.37)	50 (60)	50 (55)	430 (480)	35 (39)	5.5 (6.6)	2800 (3400)	≤70	98.5	63×60×67

The data are only for reference in the form the factory does not issue a separate notice to data modification
表中数据仅供用户选型时参考, 工厂对数据修改不另行通知

旋涡气泵

VORTEX GAS PUMP



HG-7500SB

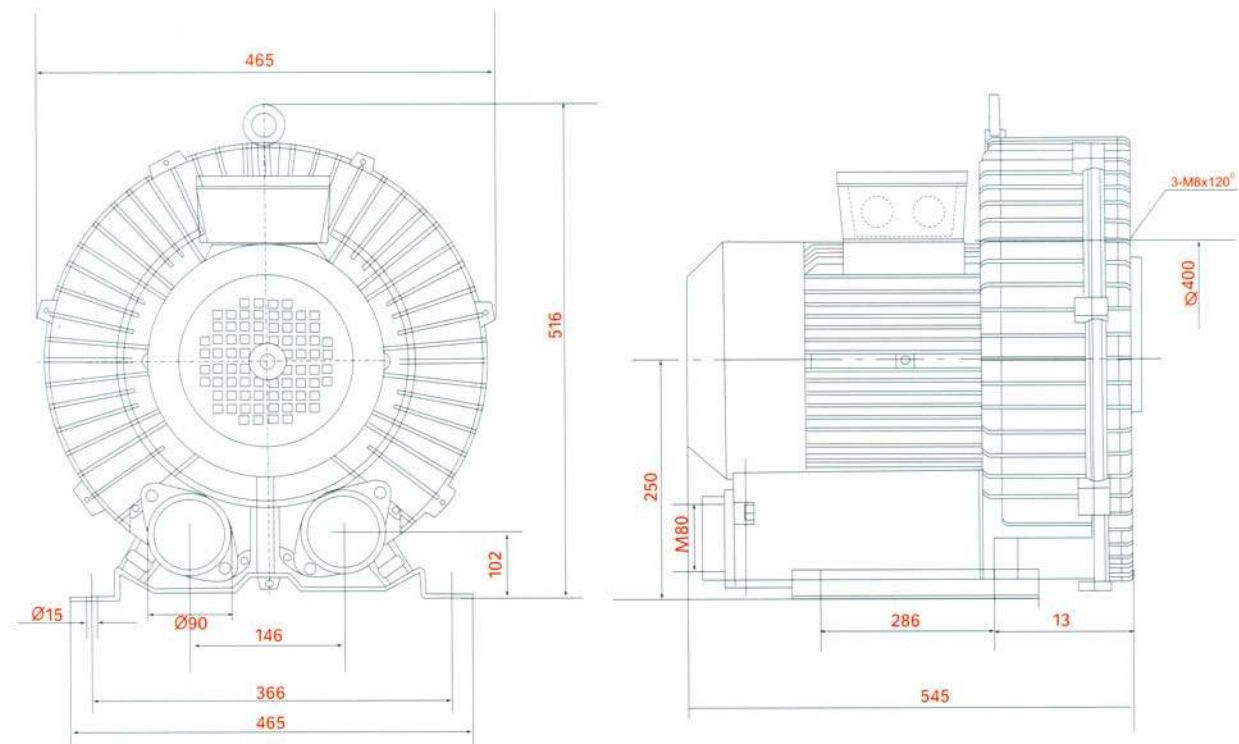

HG系列旋涡气泵性能曲线
(仅供参考不作检测依据)

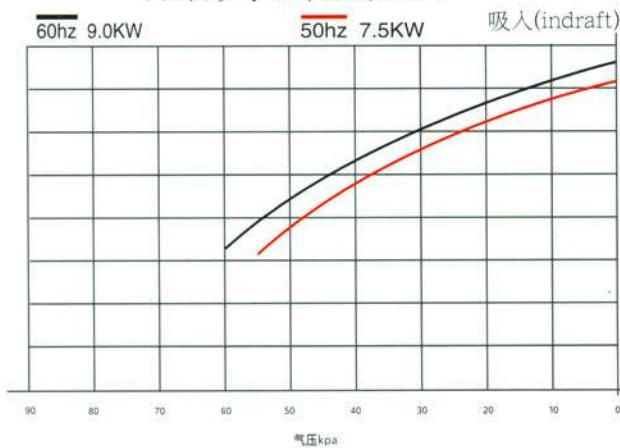

the technology parameter of the HG series vortex gas pump
(only for reference,not for test gist)

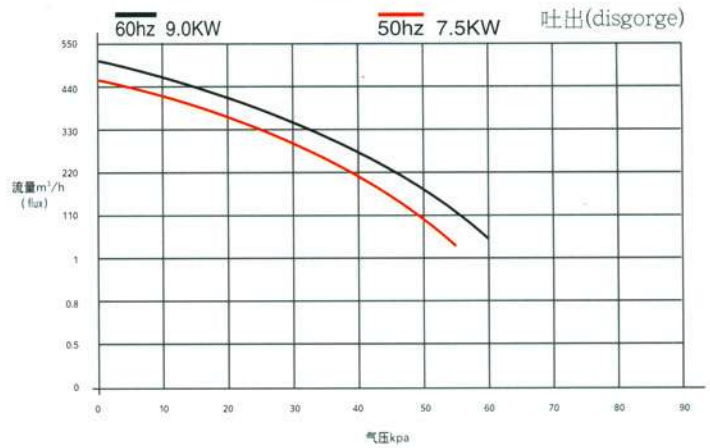

When ordering, please indicate voltage and periodicity (any voltage are also ok)
订货时, 请注明电压及周波数 (任何电压均可)

型 号 Type	额定电压 Voltage V	额定电流 Currnet A	频率 Fre- quency Hz	最大气压 Max. air pressure KPa	最大流量 Max. flux M³/h	最大真空度 Max. vacu- um degree -KPa	电机功率 Power KW	转速 Rotate speed r/min	噪音 Noise LwadB	重量 Suttle Kg	装箱体积 box up vol- umn (cm³)
HG-7500SB	△380-415	13.56 (19.74)	50 (60)	55 (60)	450 (500)	38 (42)	7.5 (9.0)	2800 (3400)	≤70	103	103×60×69

The data are only for reference in the form the factory does not issue a separate notice to data modification
表中数据仅供用户选型时参考, 工厂对数据修改不另行通知